

Pumping Station - D Tank - Dual Pumps (15,000 L)

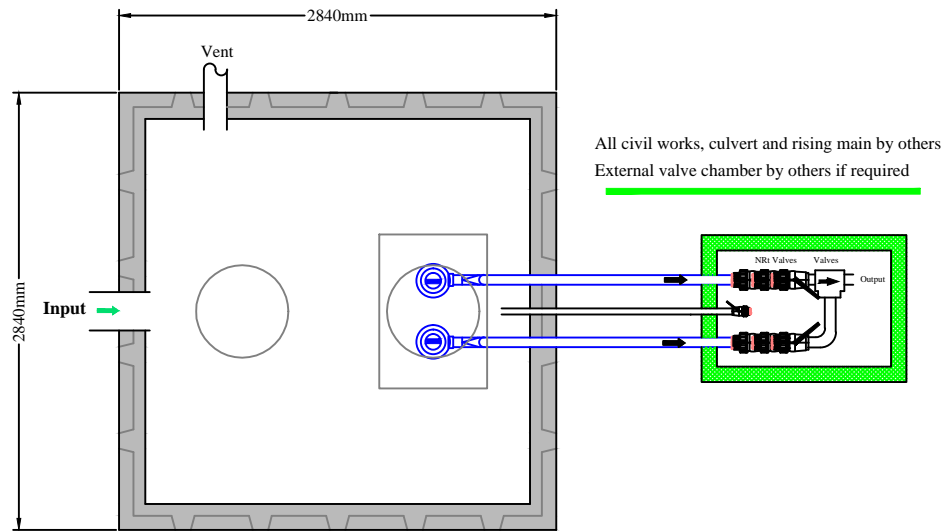

Adjustments can be made to pumping station according to customer requirements.

Variety of pumps available. Contact Molloy Precast for suitable pump.

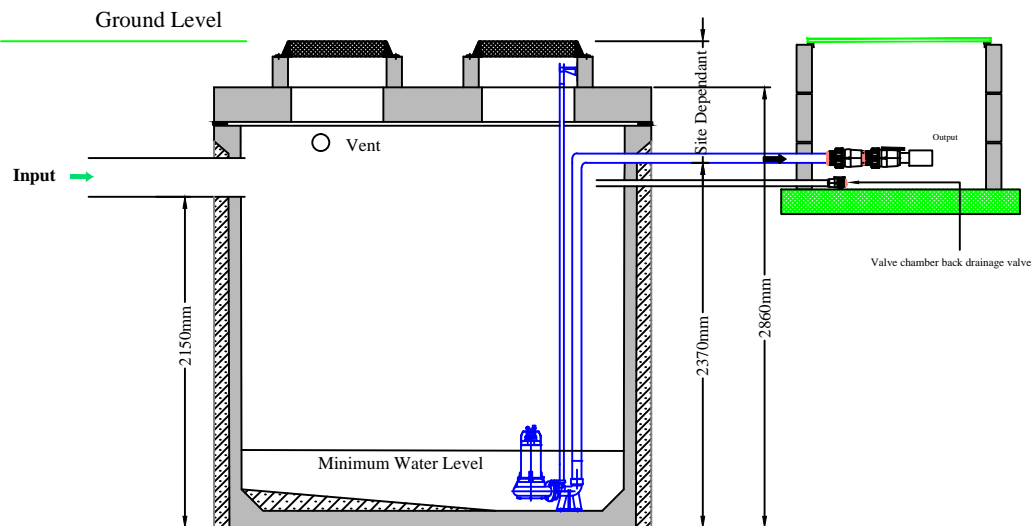

A good firm, rock free, level base is required.



Clara Road, Tullamore, Co. Offaly, Ireland
 Tel: 057 9326000 info@molloyprecast.com
 Fax: 057 9326060 www.molloyprecast.com

Note: Observe all safety regulations in regard to excavation and lifting requirements. Never leave opening uncovered or unattended at any time.
Note: Specify any specific requirements prior to ordering. All civil works by customer.
Note: Do not scale from this drawing. Only for illustration purposes.

Tank Type: D	Title: Pumping Station - D - Dual Pumps
Tank Size: 2840mm x 2840 mm	Pump Capacity: Contact Molloy Precast
Height: 2370mm (Site Dependant)	Date: June 2012
Volume: 15000 liters	Drng. No.: PS-D(2)-00
Weight: 10000 kg	Drawn By: MFC
(Tank Dim: ± 20mm. Weight: ± 30Kg.)	This drawing is ©. All rights reserved.